

TILLAMOOK COUNTY SURVEYORS OFFICE

Township corner common to

Section 36 T.4N.,R.11W.,W.M., Section 31 T.4N.,R.10W.,W.M.  
Section 1 T.3N.,R.11W.,W.M., Section 6 T.3N.,R.10W.,W.M.,

T4N R10W  
36131  
----+----  
1 | 6  
R11W T3N  
1973 RS954

I found a 2 1/2" iron pipe with a 3 1/4" Crown Zellerbach Brass Cap in a small amount of concrete. I added more concrete to the found monument and referenced to found objects as shown below.

-----  
History of found Monument

This monument is the monument reset by Robert A. Hovden RS 954 on Clatsop County Surveyors map #B-5193 from the NE corner of lot 1 block 1 Falcon Heights subdivision.

I found a 1" iron pipe at the NW corner of lot 4 block 4 Falcon Heights approximately 2" deep in pavement, leans slightly to the South, S.56\*14'34"E. 53.82'; (Computed record for this point, from Falcon Heights subdivision by Wilbur Markham RE 1842 Tillamook County Surveyors map #C-161, is S.55\*58'06"E. 54.08'). I affixed a Tillamook County Surveyors brass washer to position tied.

I found a 1/2" iron pipe at NE corner of lot 1 block 1 Falcon Heights, approximately 1' deep, S.9\*48'14"W. 30.41'; (field and record value are identical). I encased in an irregular mass of concrete and used for basis of bearings.

PP&L Power pole N.44\*E. 39.5' set by Robert A. Hovden LS954 Mar. 12, 1973 Clatsop County Rewitness BT-714-6; (Now N.42\*27'32"E. 39.5'. The distance was measured to the side center of the pole. The angle was turned between the "R" and the "E" in the word "TREE" on the bearing tree tag. The distance on the tag is marked 34.5', should be 39.5'. The pole is now a P.U.D. pole #310000).

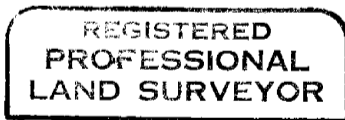

*Allan E. Duncan*

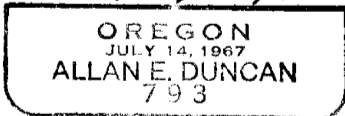

Tillamook County Surveyors Office

-----  
New Accessory

\*72" hat section post S.81\*E. 11.55'.

\* Indicates yellow Tillamook County corner tag affixed.

-----  
Surveys of Reference:

See miscellaneous section file S15 T3NR10W for a copy of the  
rewitness furnished by Clatsop County Surveyors Office.

A-1005	1948	W.A. Markham	PE 1842
F-40-353	1965	Arne Jarvi	LS 244
A-4735	1982	John E. Hollingsworth	LS 691
A-4579	1981	Colin H. Handforth	LS 1205
B-1029	1981	John E. Hollingsworth	LS 691

Rewitness book 6 pages 211-212, 218, & 182 Narratives for  
map #A-4735 And #B-1029 by John H. Hollingsworth RS 691.

Also see Tillamook County field note bin S6 T3NR10W (1939  
Oregon Dept. of Transportation field notes).

-----  
Monument Location

This corner is located on the North side of a gravel beach  
access, approximately 12' West of the end of truck travel.

-----  
In the presence of Dan McNutt & Al Dvorak

December 20, 1990

Title

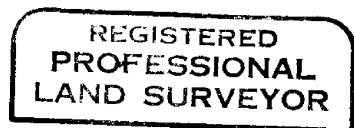

*Allan E. Duncan*

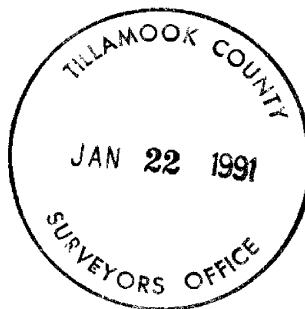
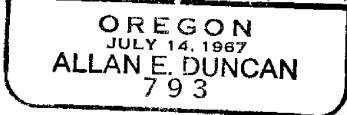

page 2 of 2